

Light System & Procedure

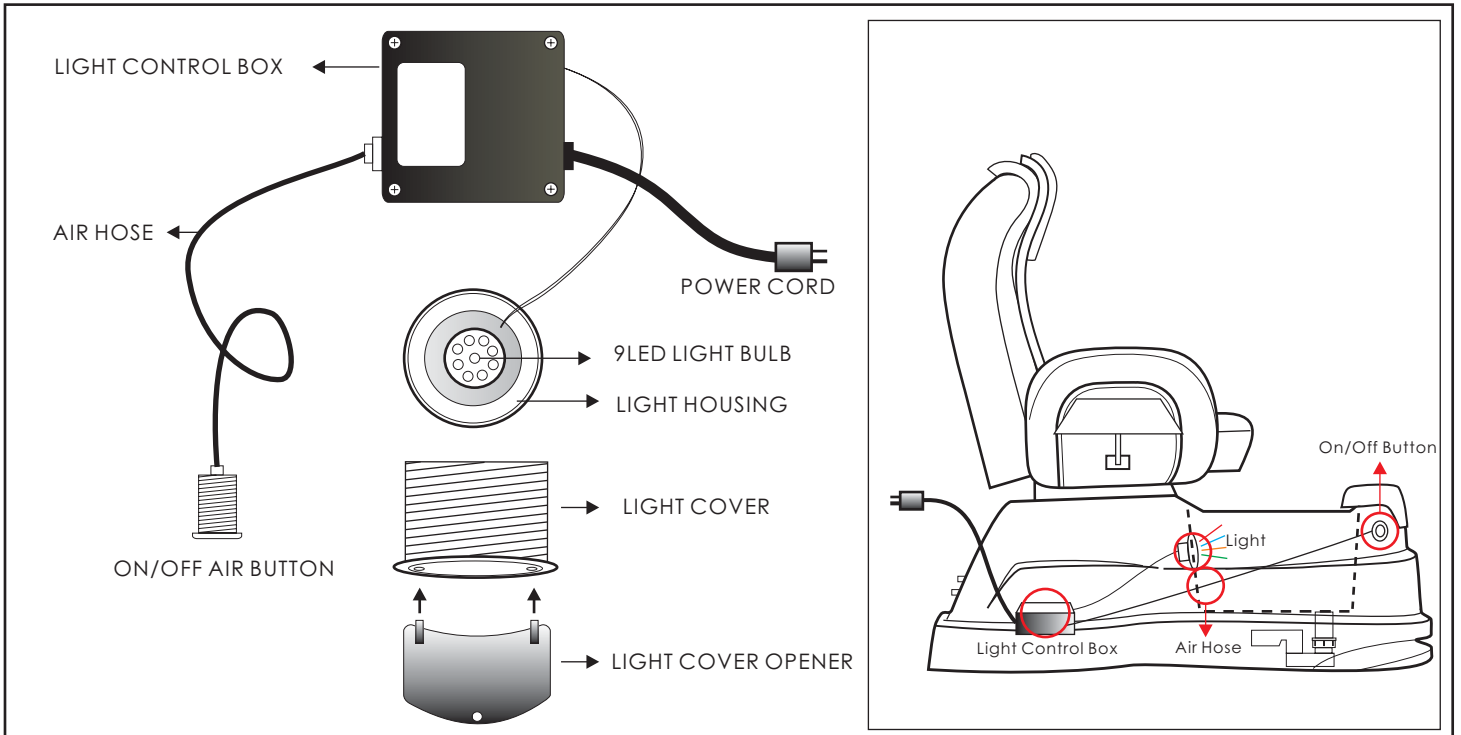

To turn the light on:
Press the On/Off button

To turn the light off:
Press the On/Off button while light is turned on

To change the color to next setting:
Turn off the light by pressing the On/Off button while the light is on, then quickly turn it back on by pressing On/Off button

To keep the same color
Turn off the light by pressing the On/Off button and wait (3) seconds, then turn the light back on by pressing the On/Off button

Initial Color	Setting	Colors	Sequence
Blue Red	steady steady	Blue only Red only	Steady Blue Steady Red
Green Blue & Red	steady steady	Green only Blue & Red	Steady Green Steady Magenta (Blue+Red)
Blue Red	change change	Blue & Green Red, Green & Blue	Blue- Blue+Green- Green- Green+Blue Red- Red+Green- Red+Green+Blue- Red+Blue- Red- Red+Green- Red+Blue
Mixed Mixed	change steady	Red, Green & Blue Red, Green & Blue	All colors change in 0.5 seconds Steady White (Red+Green+Blue)
Green Green & Red	change steady	Red, Green & Blue Green & Red	All color changes slowly Green+Red

When light is not turning on:

- 1) Please check the "Power Cord" from the light control box
 - Make sure the power cord is connected to your electric source and check your surge protector
- 2) Please check the "Air Hose"
 - Make sure both end of air hose is properly connected from the On/Off button to the Light Control box
- 3) Please check your "Electric Source"
 - If your power cord is connected through the surge protector, please make sure your surge protector is on
- 4) Please check your "Light Bulb"
 - Remove the light cover by using a Light Cover Opener, then remove the light bulb. Gently re-insert the light bulb